

# EDGEWOOD ACRES THIRD ADDITION

PART OF LOT 21 OF THE RECORDED PLAT OF EDGEWOOD ACRES, RECORDED IN CABINET L, PAGES 55-59 (DOC #1998650), OUTAGAMIE COUNTY RECORDS, LOCATED IN PART OF THE SOUTHWEST 1/4 OF THE NORTHEAST 1/4 AND PART OF THE NORTHWEST 1/4 OF THE NORTHEAST 1/4 OF SECTION 10, T21N-R17E, TOWN OF GRAND CHUTE, OUTAGAMIE COUNTY, WISCONSIN.

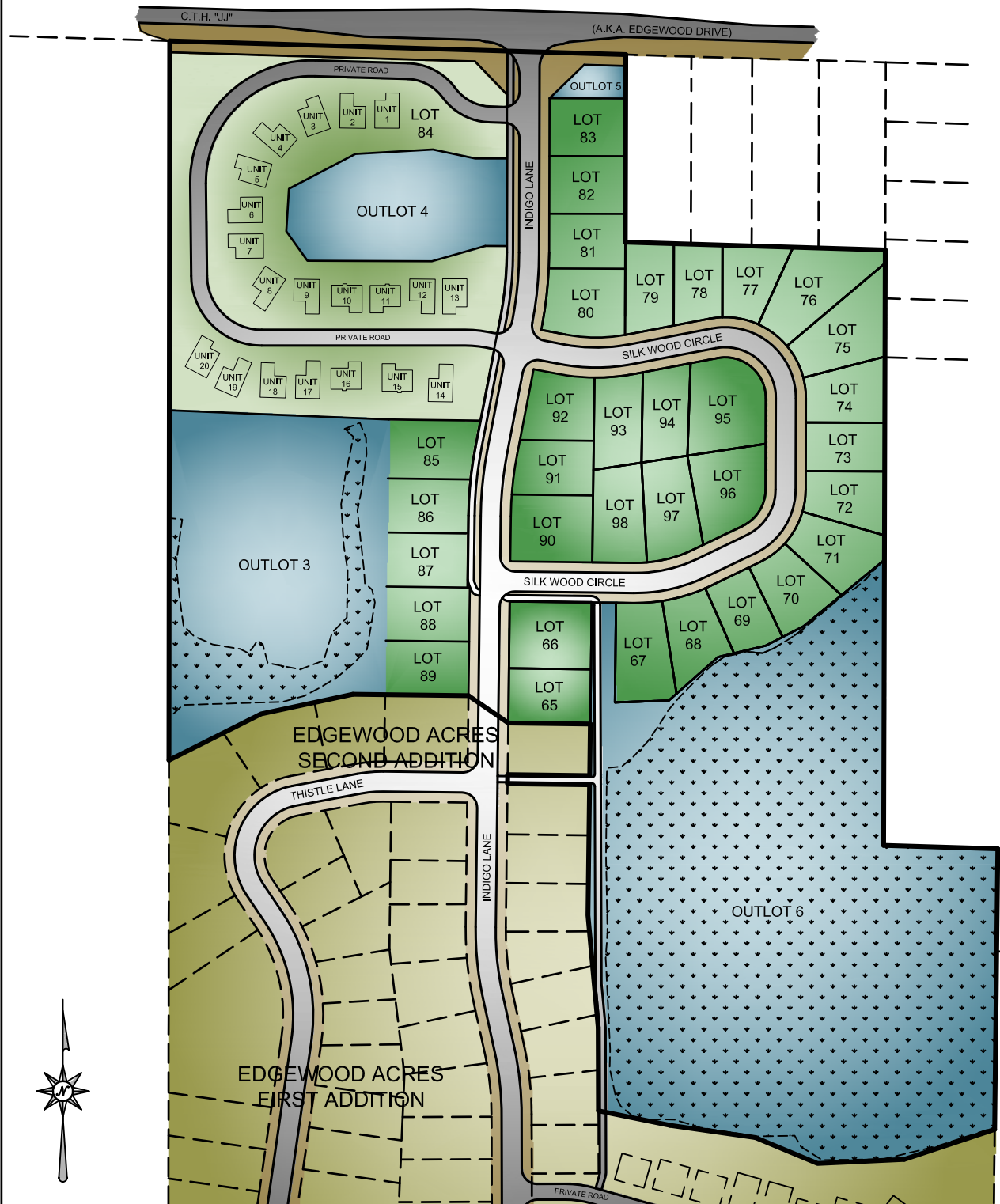

2280 Salschneider Court Green Bay, WI 54313  
PH: 920-569-5765; Fax: 920-569-5767  
www.mach-iv.com